

Series 4, heat pump dryer, 8 kg WTH85222GB



A++

The dryer for especially efficient drying: energy efficiency class A++.

- **EasyClean with A++:** dries very efficient. With easy cleaning of the condenser filter.
- **AutoDry:** gently dries laundry to precisely the degree of dryness you want.
- **AntiVibration Design:** extremely stable and comfortably quiet thanks to special vibration protection.
- Climate friendly dryer with the most environmental friendly agent (R290).
- LED Display with end-or start-time delay of up to 24 hours.

Technical Data

Built-in / Free-standing : Free-standing
 Removable top : No
 Door hinge : Right
 Color / Material body : White
 Length electrical supply cord : 145.0 cm
 Height of removable worktop : 0 mm
 Dimensions of the product : 842 x 598 x 613 mm
 Net weight : 46.6 kg
 Drum volume : 112 l
 Fluorinated greenhouse gases : No
 Type of refrigerant : R290
 Hermetically sealed equipment : Yes
 Quantity of fluorinated gases : 0.115 kg
 The quantity expressed in CO₂ equivalent : 0.000 t
 Connection Rating : 625 W
 Fuse protection : 10 A
 Voltage : 220-240 V
 Frequency : 50 Hz
 Approval certificates : CE, E17D UKCA marking, VDE
 Drying process : automatic
 Capacity cotton - NEW (2010/30/EC) : 8.0 kg
 Energy efficiency rating : A++
 Energy consumption electric dryer, full load - NEW (2010/30/EC) : 1.87 kWh
 Standard cotton programme time at full load : 205 min
 Energy consumption electric dryer, partial load - NEW (2010/30/EC) : 1.14 kWh
 Standard cotton programme time at partial load : 130 min
 Weighted annual energy consumption, electric dryer - NEW (2010/30/EC) : 236.0 kWh/annum
 Power consumption in off-mode - NEW (2010/30/EC) : 0.10 W
 Power consumption in left-on mode - NEW (2010/30/EC) : 0.75 W
 Weighted programme time : 162 min
 Condensation efficiency class - NEW (2010/30/EC) : B
 Average condensation efficiency full load (%) : 81 %
 Average condensation efficiency partial load (%) : 81 %
 Weighted condensation efficiency (%) : 81 %



Series 4, heat pump dryer, 8 kg WTH85222GB

**The dryer for especially efficient drying:
energy efficiency class A++.**

engine power and consumption

Programmes

- Special programmes: shirts/blouses, Down wear, Towels, Mixed Load, Super Quick 40 minutes program, Sportswear, Wool Finish, Timed Program Cold, Timed Program Warm

options

- Touch control buttons: Start / Reload / Pause, Low Heat, less ironing, programme length, Fine-tuning of drying aim, 24 h end time delay

comfort and safety

- Easy clean filter for easy maintenance
- AutoDry technology
- Fully electronic control dial for sensor drying programmes, timed and special programmes
- LED-Display for remaining time and 24 h end time delay, programme status indication, special functions
- Sensitive Drying System: Big Stainless steel drum with textile care structure, soft design paddles
- AntiVibration Design: more stability and quietness
- Drain Set
- Indication for full condensation tank
- Indication for cleaning of filter
- Child-proof lock
- Anti crease cycle after the end of the programme
- Buzzer to indicate the end of cycle
- Glass door with frame silver-white
- comfort lock
- Door hinge: right-hand
- Metal door closing hook

Technical Information

- Slide-under height of 85cm
- Dimensions (H x W): 84.2 cm x 59.8 cm
- Appliance depth: 61.3 cm
- Appliance depth incl. door: 66.5 cm
- Appliance depth with open door: 110.5 cm
- Heat pump technology with eco-friendly cooling agent R290

Series 4, heat pump dryer, 8 kg WTH85222GB

Measurements in mm

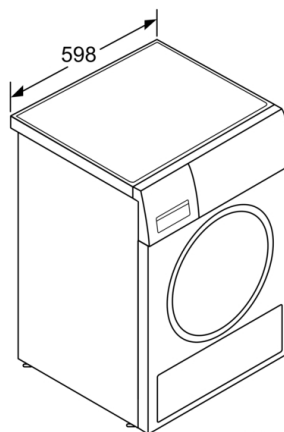
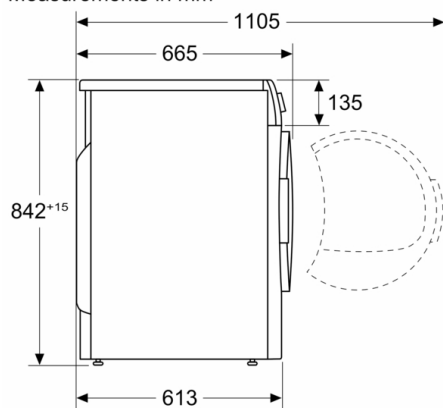

measurements in mm