

Series 6, heat pump dryer, 8 kg WTR87T82GB



A++

The dryer for high drying performance with low energy consumption of A+++.

- **EasyClean with A++:** dries very efficient. With easy cleaning of the condenser filter.
- **AutoDry:** gently dries laundry to precisely the degree of dryness you want.
- **AntiVibration Design:** extremely stable and especially quiet thanks to special vibration protection.
- **Big LED Display:** easy operation and extra functions available.
- **SensitiveDrying System:** gentledrying without wrinkling thanks to its unique drum design and movements.

Technical Data

Built-in / Free-standing : Free-standing
 Removable top : No
 Door hinge : Right
 Color / Material body : White
 Length electrical supply cord : 145.0 cm
 Height of removable worktop : 0 mm
 Dimensions of the product : 842 x 598 x 613 mm
 Net weight : 56.4 kg
 Drum volume : 112 l
 Fluorinated greenhouse gases : No
 Type of refrigerant : R290
 Hermetically sealed equipment : Yes
 Quantity of fluorinated gases : 0.120 kg
 The quantity expressed in CO₂ equivalent : 0.000 t
 Connection Rating : 600 W
 Fuse protection : 10 A
 Voltage : 220-240 V
 Frequency : 50 Hz
 Approval certificates : CE, E17D UKCA marking, VDE
 Drying process : automatic
 Capacity cotton - NEW (2010/30/EC) : 8.0 kg
 Energy efficiency rating : A++
 Energy consumption electric dryer, full load - NEW (2010/30/EC) : 1.86 kWh
 Standard cotton programme time at full load : 200 min
 Energy consumption electric dryer, partial load - NEW (2010/30/EC) : 1.13 kWh
 Standard cotton programme time at partial load : 125 min
 Weighted annual energy consumption, electric dryer - NEW (2010/30/EC) : 235.0 kWh/annum
 Power consumption in off-mode - NEW (2010/30/EC) : 0.10 W
 Power consumption in left-on mode - NEW (2010/30/EC) : 0.75 W
 Weighted programme time : 157 min
 Condensation efficiency class - NEW (2010/30/EC) : B
 Average condensation efficiency full load (%) : 83 %
 Average condensation efficiency partial load (%) : 83 %
 Weighted condensation efficiency for the standard cotton programme at full and partial load : 83 %



Series 6, heat pump dryer, 8 kg WTR87T82GB

**The dryer for high drying performance with
low energy consumption of A+++.**

engine power and consumption

Programmes

- standard programmes: cotton, easy care
- Special programmes: shirts/blouses, Delicates, Towels, Mixed Load, Super Quick 40 minutes program, Sportswear, Wool Finish, Timed Program Cold, Timed Program Warm

options

- Anti crease cycle 60 min at the end of the programme
- Touch control buttons: end time delay, less ironing, programme length, Low Heat, Signal, Start / Reload / Pause, Fine-tuning of drying aim, 24 h end time delay

comfort and safety

- EasyClean filter
- AutoDry technology
- soft dial
- Large LED-Display for remaining time and 24 h end time delay, programme status indication, special functions.
- Sensitive Drying System: Big Stainless steel drum with textile care structure, soft design paddles
- AntiVibration Design: more stability and quietness
- Drum interior light: LED
- Child-proof lock
- Buzzer to indicate the end of cycle
- Glass door with frame silver-white
- Metal door closing hook
- Door hinge: right-hand
- Drain Set

Technical Information

- Slide-under height of 85cm
- Dimensions (H x W x D): 84.2 cm x 59.8 cm x 61.3 cm
- Dimensions (H x W): 84.2 cm x 59.8 cm
- Appliance depth: 61.3 cm
- Appliance depth incl. door: 66.5 cm
- Appliance depth with open door: 110.5 cm
- Heat pump technology with eco-friendly cooling agent R290

Series 6, heat pump dryer, 8 kg
WTR87T82GB

Measurements in mm

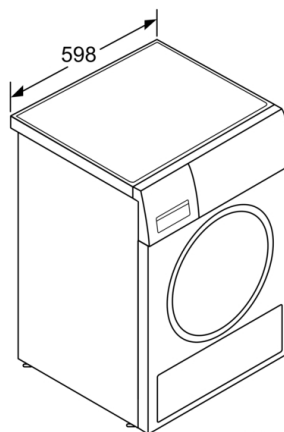
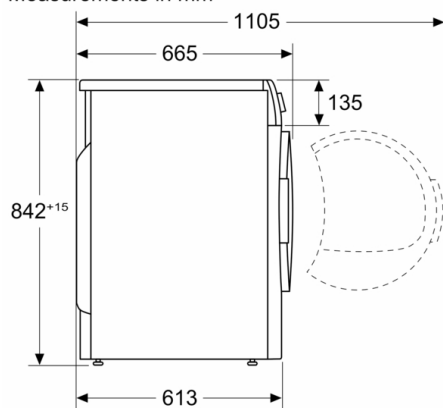

measurements in mm