

Long TV Ceiling Mount

Black

Black &
White

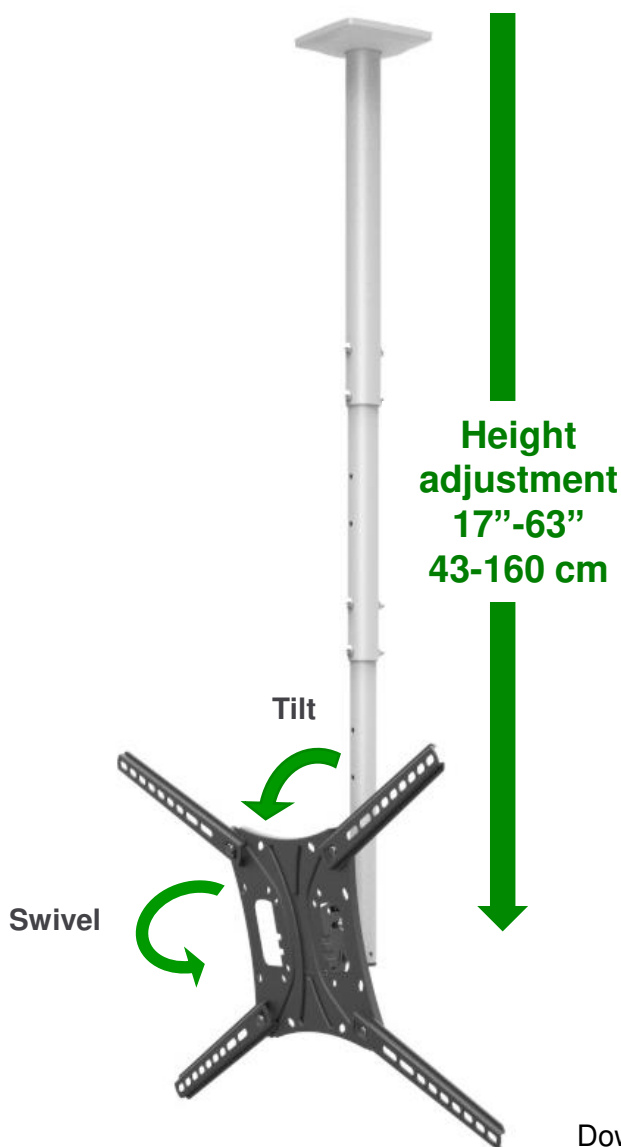

Download Assembly Instructions with Text

For more information: [barkanmounts.com](https://www.barkanmounts.com)

If you are satisfied with the product, please give us a 5 stars ★★★★★ rating on the website you bought it from. If you are not satisfied please contact us at <https://www.barkanmounts.com/support> and we will solve the problem for you.

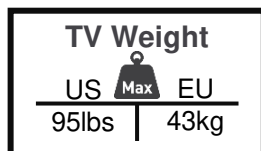

Safety instructions and installation warnings (provided separately) must be read in full, prior to assembly.

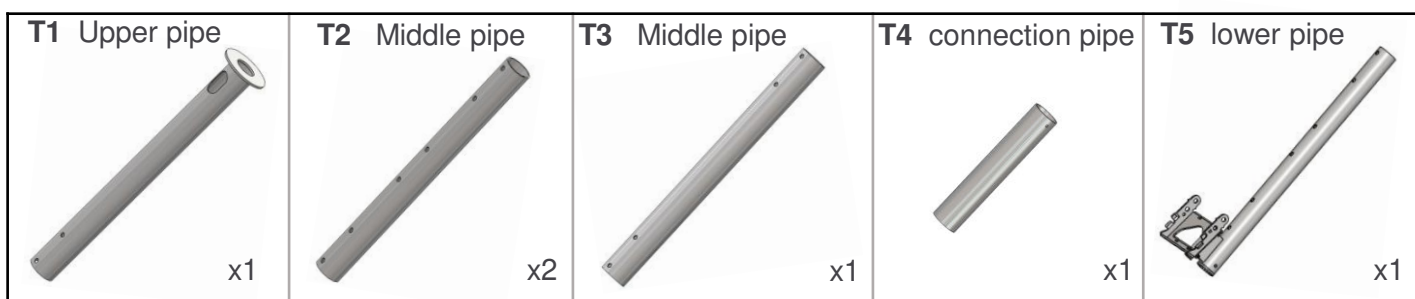

T	Diameter
T1	40 mm
T2	35mm
T3	40mm
T4	40 mm
T5	30 mm

#	M	L mm	L inch	pcs
Z1	4	20	13/16	4
Z2	6	16	5/8	4
Z3	6	25	1	4
Z4	8	25	1	4
Z5	8	45	1 13/16	4

Required Tools

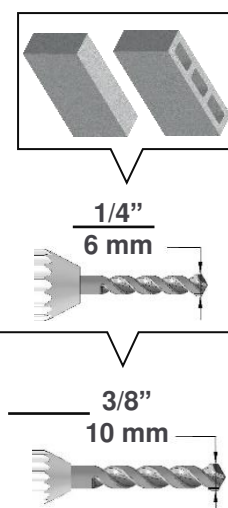
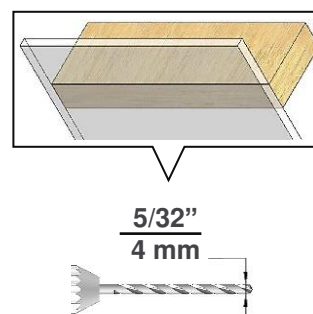
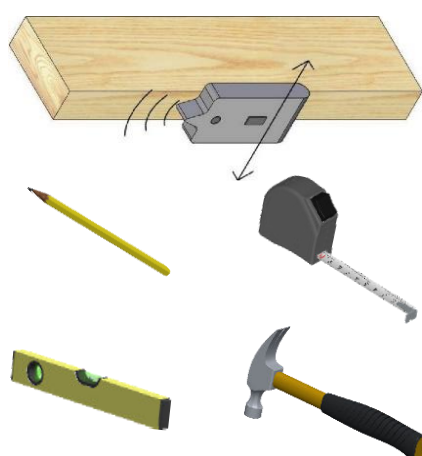

Connect the TV plate (C) to the back of the TV

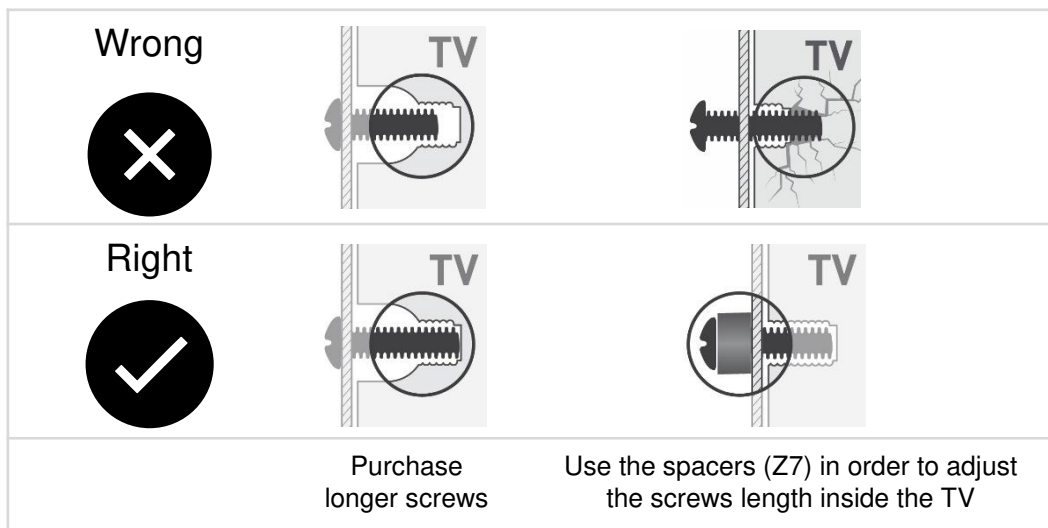

1

Continue according to your TV mounting hole pattern

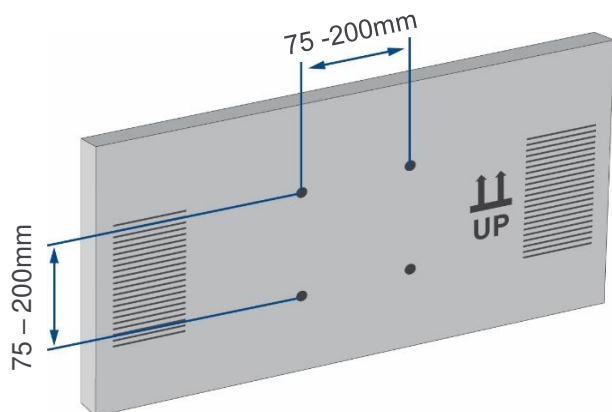

1a

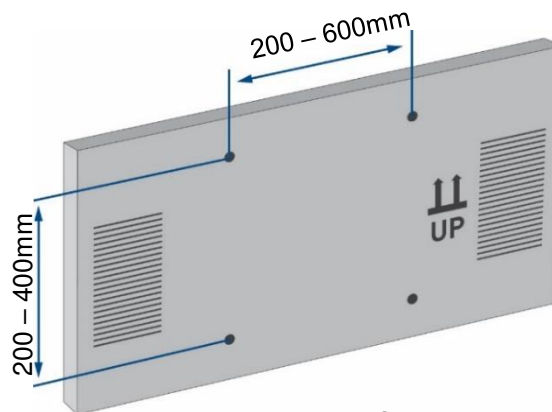

1b

1a

75x75 mm – 100X100 mm hole pattern

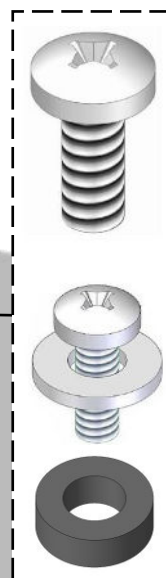
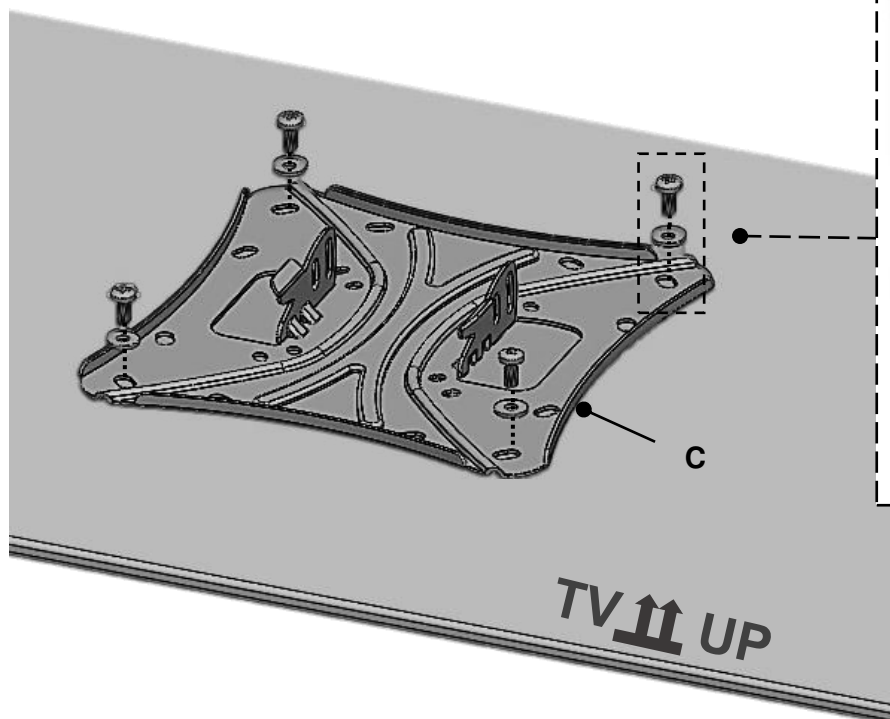

Z4/Z5

Z1/Z2/Z3

Z6

Z7 Optional



2

1b Hole pattern above 200x200 mm up to 600x400 mm:

A Disassemble the screws.

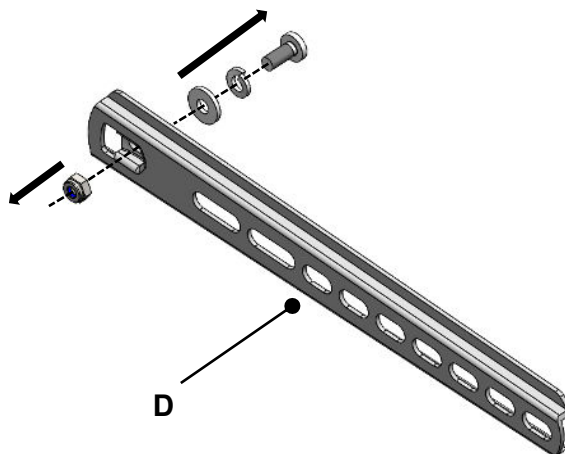

B Connect the 4 adaptors (D) to the TV plate and reassemble the screws.

Flat TV

Curved TV

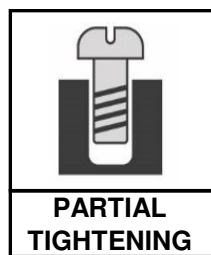
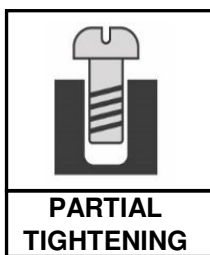
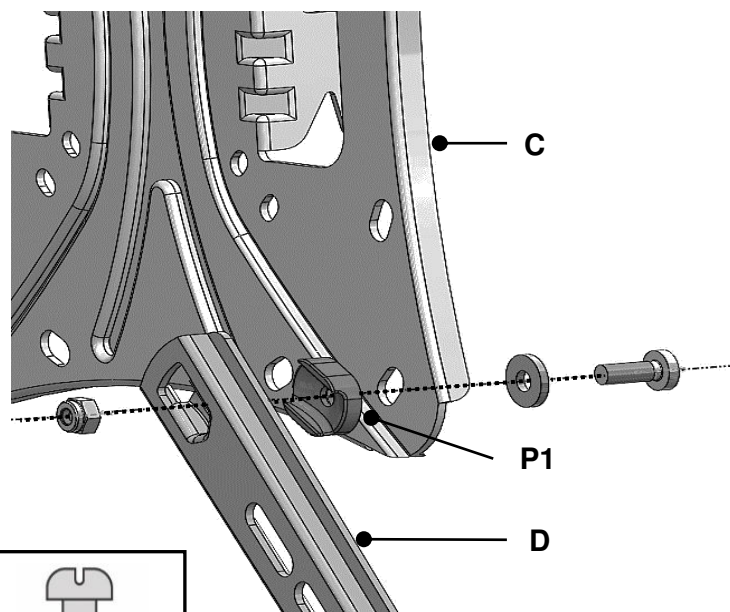
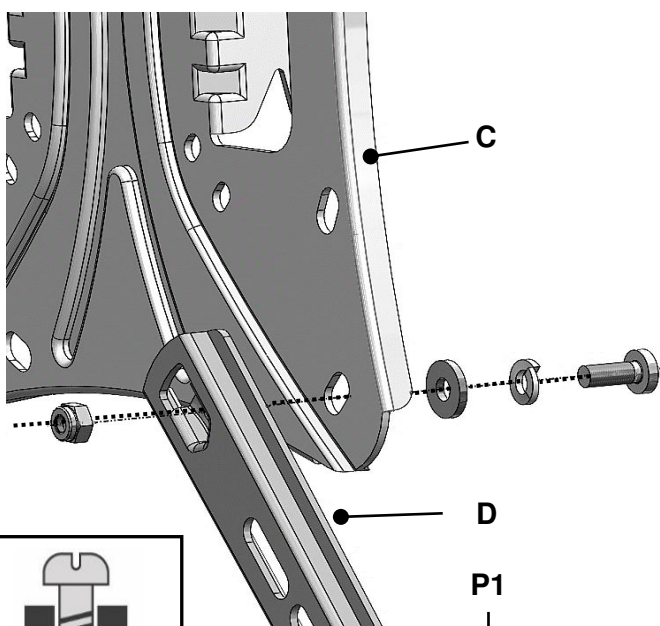

Right

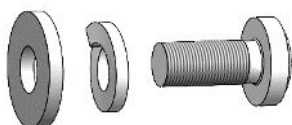

Right

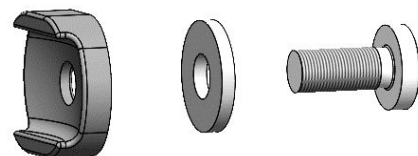

Wrong

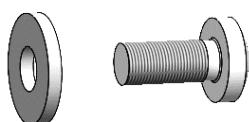

Wrong



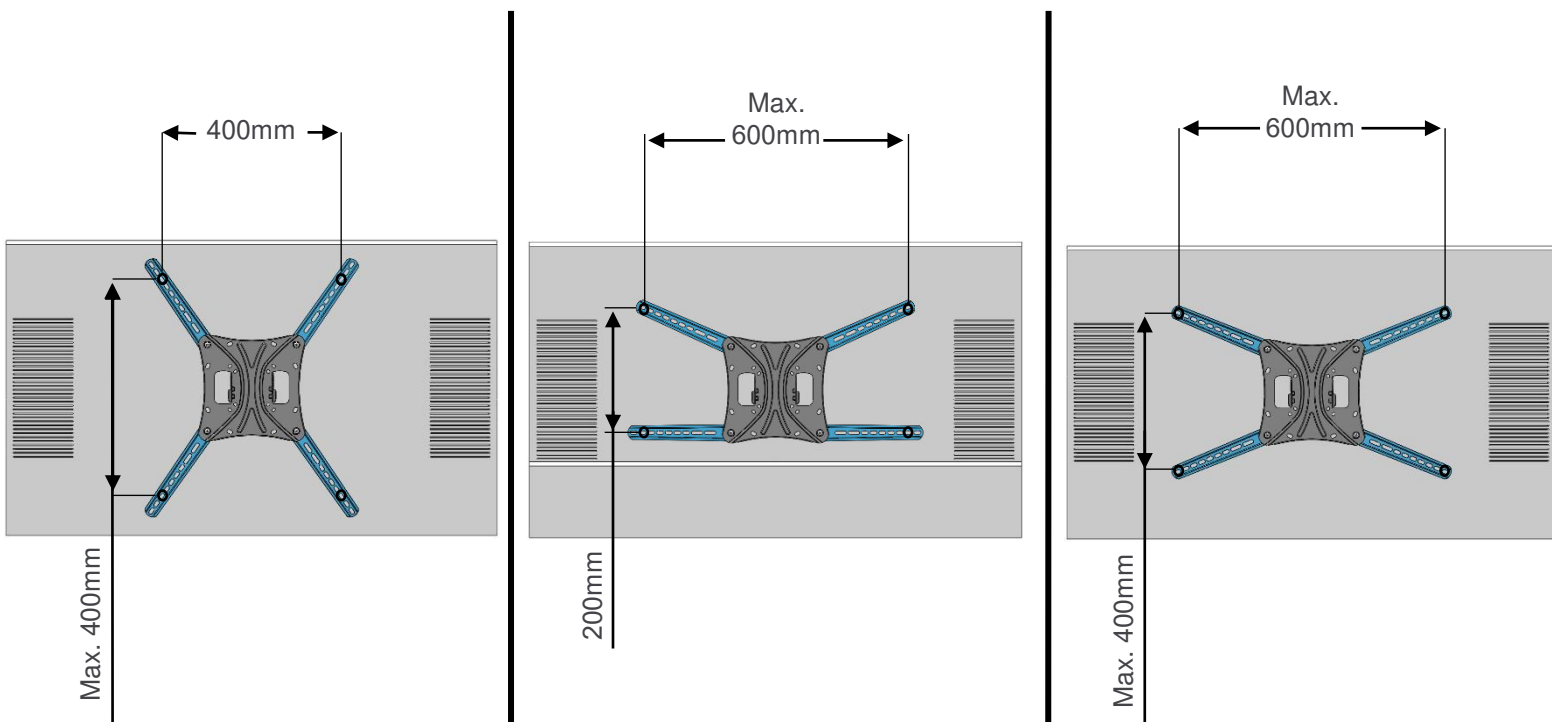

For more positioning options turn to last page

Connect the TV plate with the adaptors to the TV in all 4 connection holes. Fully tighten screws A but connect screws B without tightening them fully.

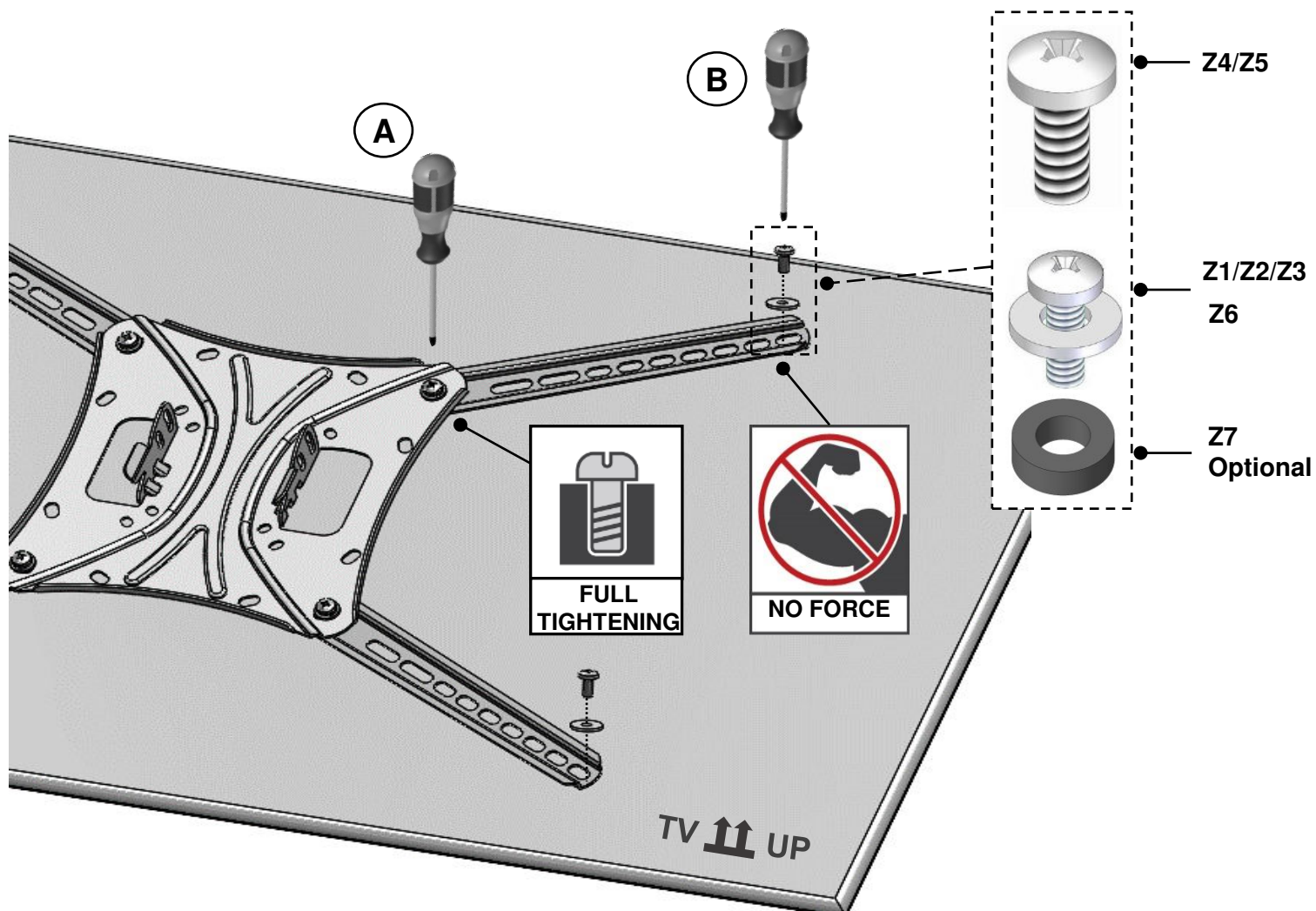

2 Follow the steps according to your ceiling type

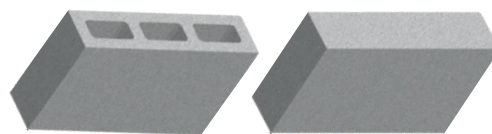
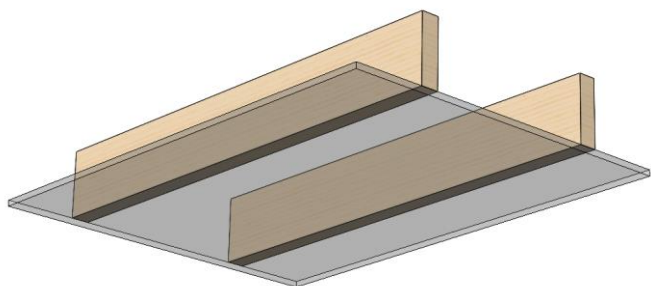

2a Make sure all holes are drilled inside the joist

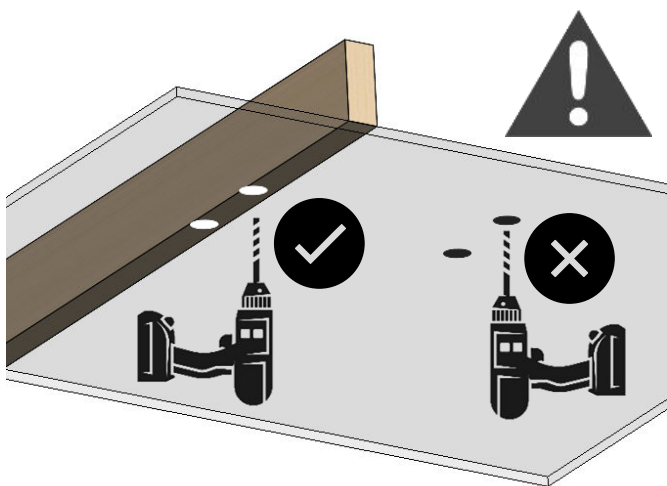

2b



Make sure there are no electrical/water lines in the ceiling before drilling

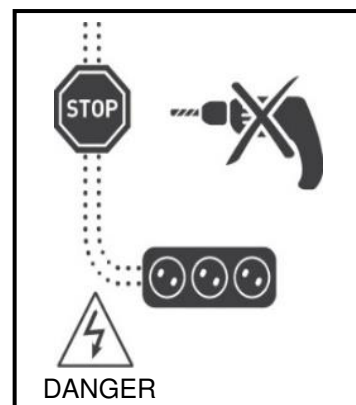

Mark the holes on the ceiling according to the required position

3a

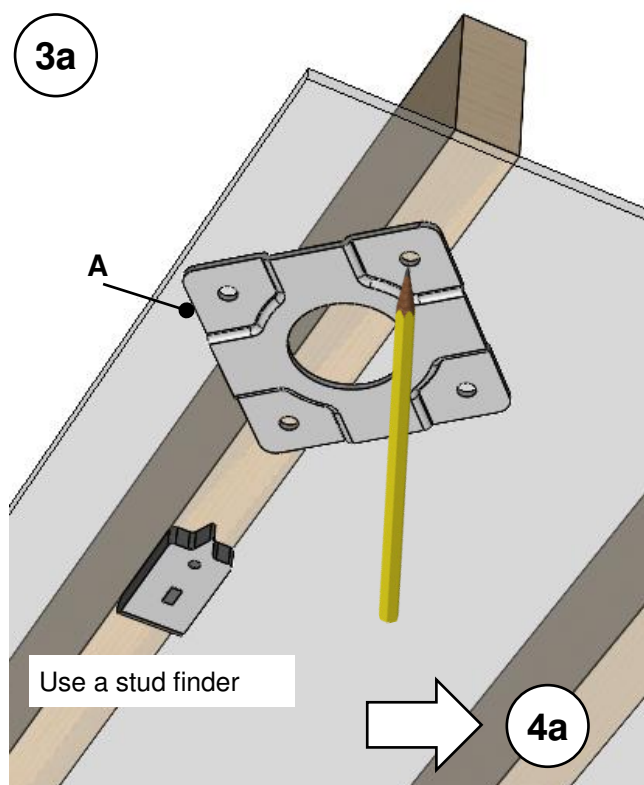

3b

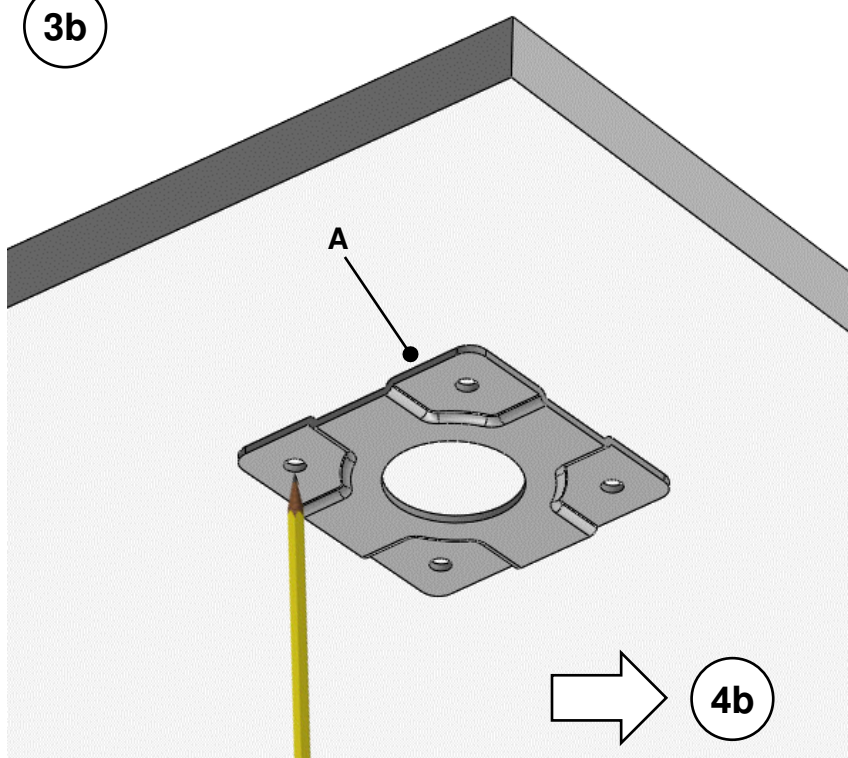

4a Drill with 5/32" \ 4mm drill bit

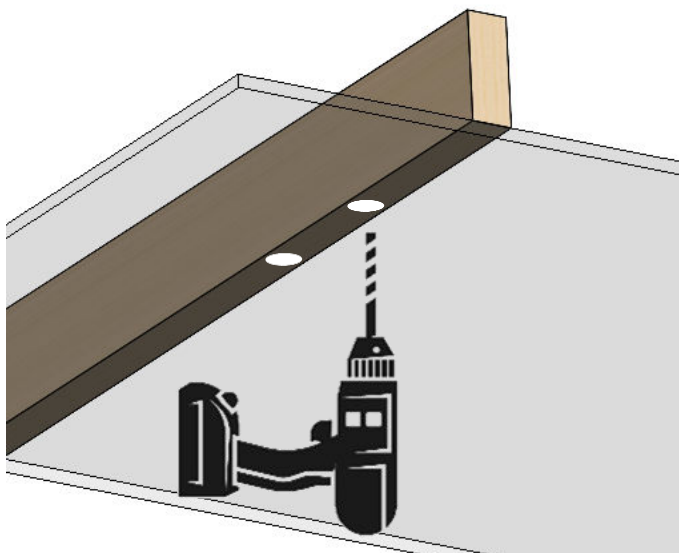

4b First use 1/4" \ 6mm drill bit and then use 3/8" \ 10mm to expand the hole

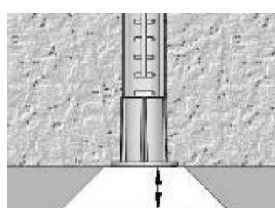
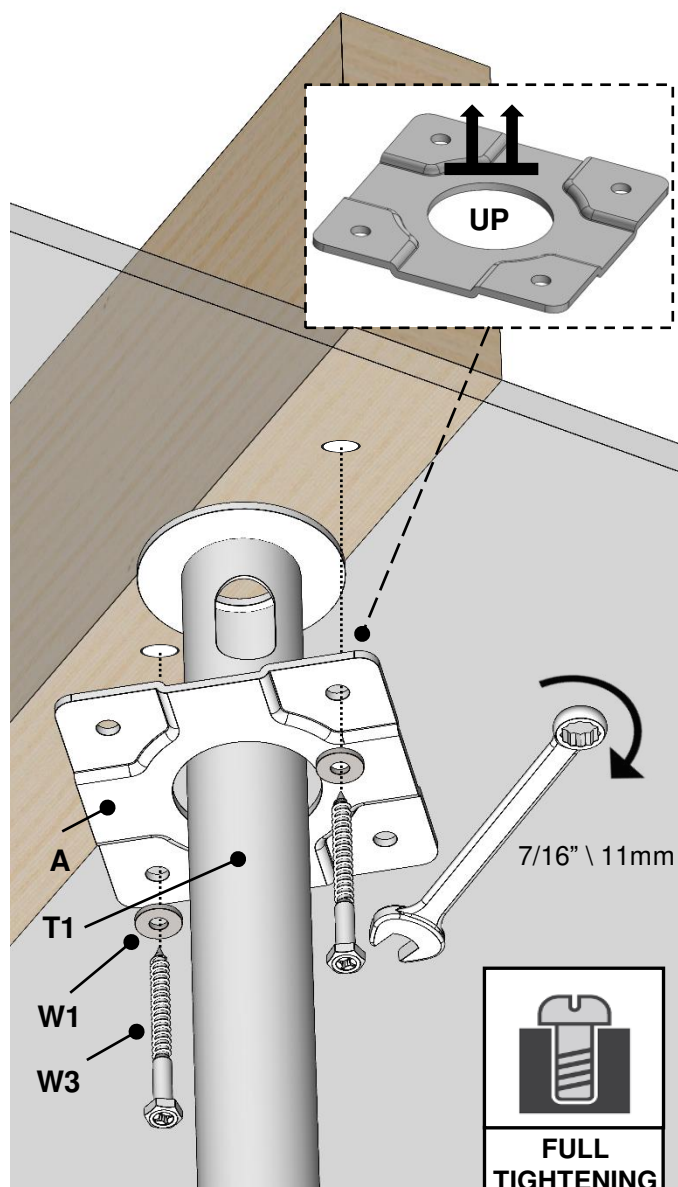
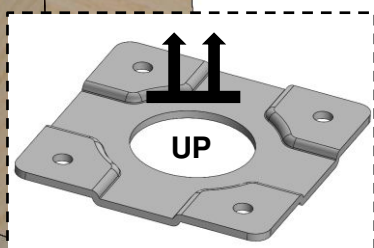
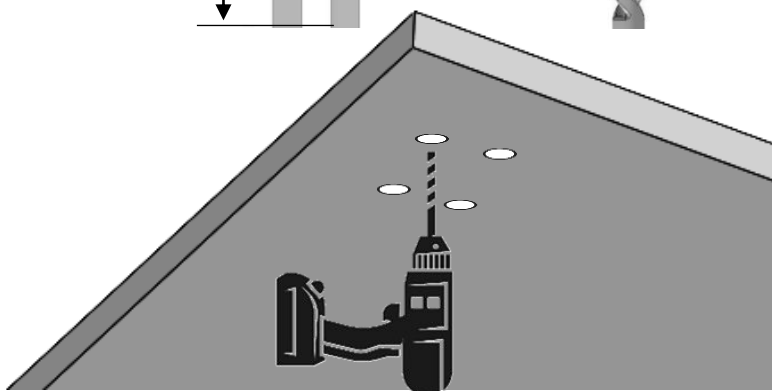
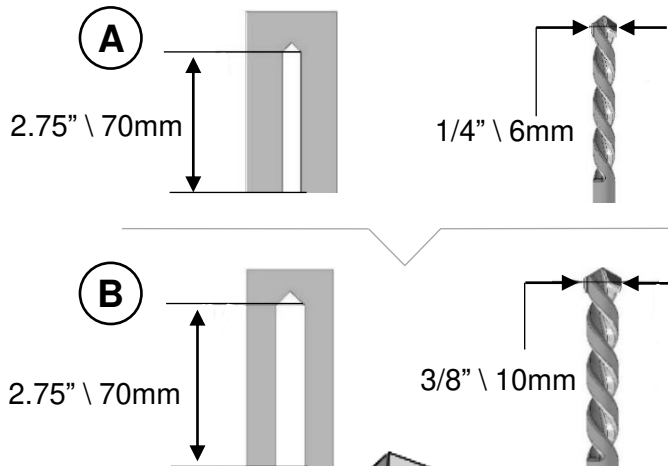

The anchor must be sunk at least 3/8" \ 10mm into the plaster coating

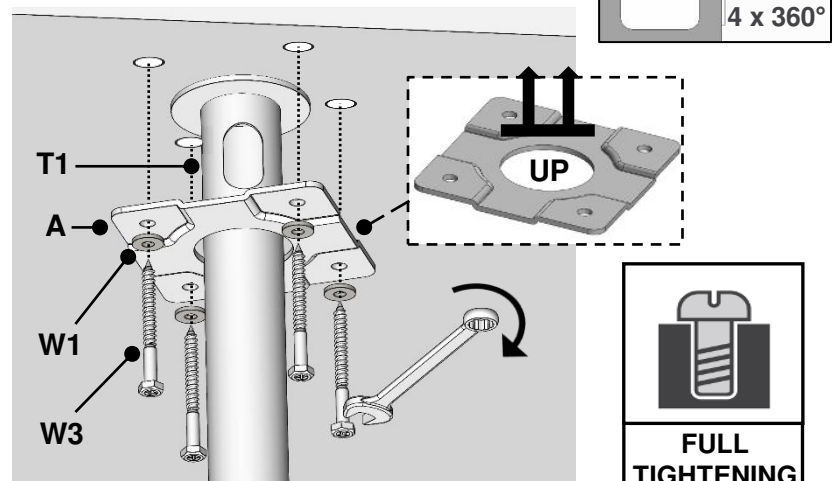
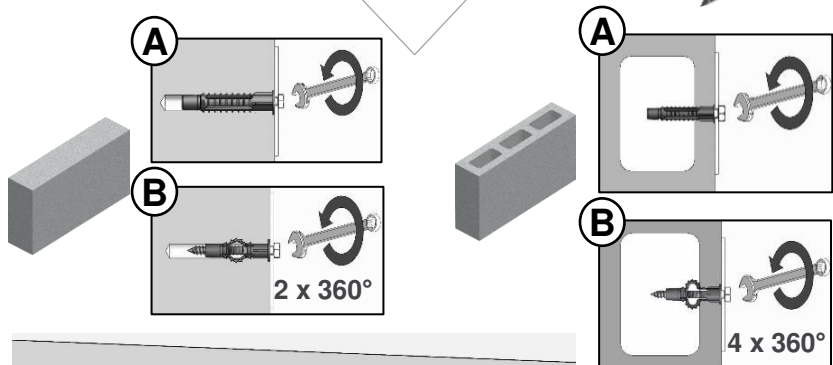
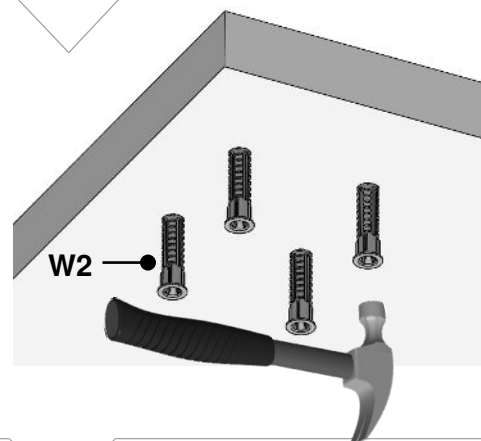

5 Weight test - Apply force on the upper pipe and make sure it is connected securely

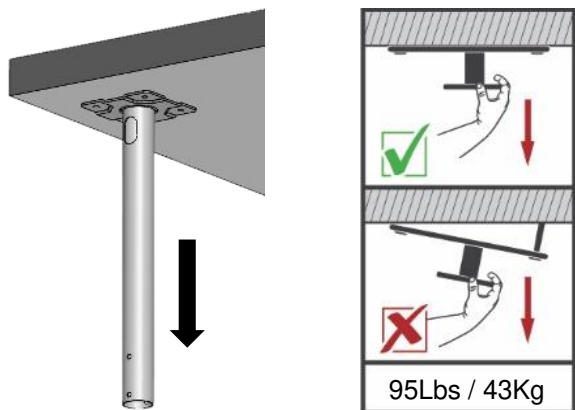

6 Assemble the ceiling plate plastic cover

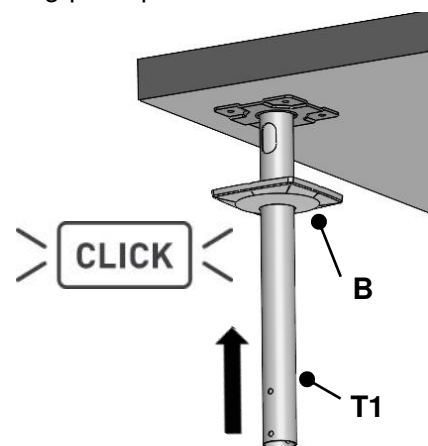

7 Assemble the mount according to the desired height of the television

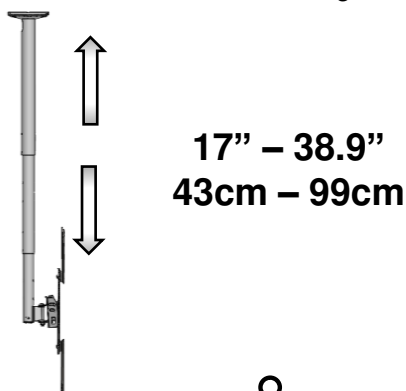

17" – 38.9"
43cm – 99cm

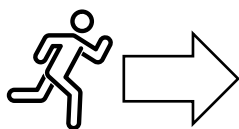

7a

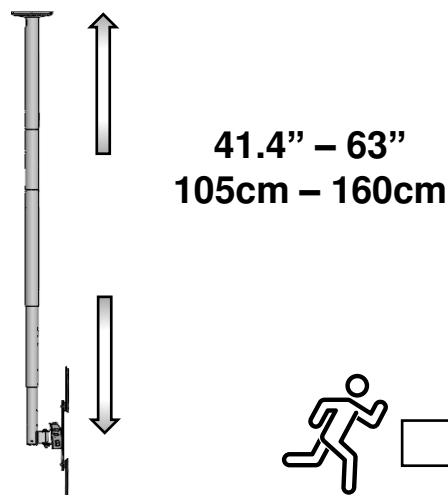

41.4" – 63"
105cm – 160cm

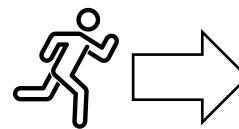

7b

7a **17" – 38.9"**
43cm – 99cm

Connect the pipes according to the desired length. Each connection is made with two Y1 screws and two Y2 nuts.

Important – You must assemble all three tubes, do not omit the middle tube T2. If necessary, you may insert the middle tube T2 in its entirety into the upper tube T1.

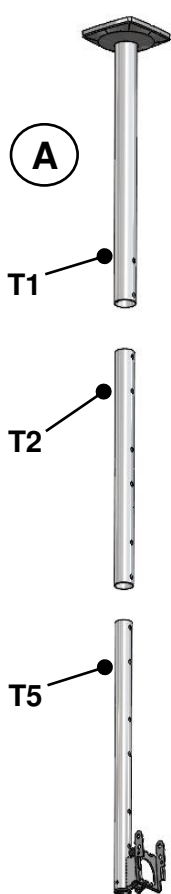

3 pipes
5 height level options:

Level	Height (inch)	Height (cm)
1	17"	43
2	22.7"	58
3	28.2"	72
4	33.7"	86
5	38.9"	99

Minimum

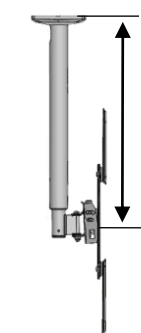

17" / 38.9cm

Maximum

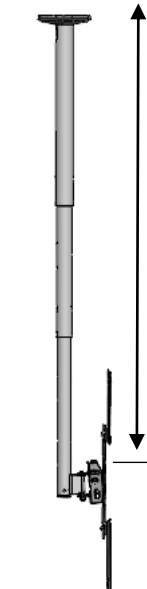

38.9" / 99cm

B

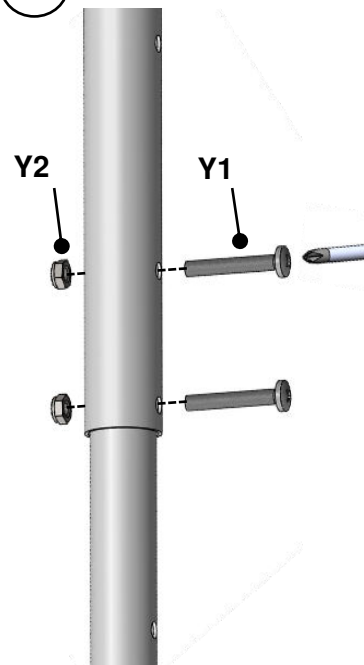

7b

41.4" – 63"
105cm – 160cm

Connect the pipes according to the desired length. Each connection is made with two Y1 screws and two Y2 nuts.

Important – You must assemble all five tubes, do not omit the middle tube T2. If necessary, you may insert both of the middle tubes T2 in their entirety into the upper tubes T1 and T4.

A

5 pipes
5 height level options:

Level	Height (inch)	Height (cm)
1	41.4"	105
2	46.9"	120
3	52.4"	133
4	57.9"	147
5	63"	160

Minimum

Maximum

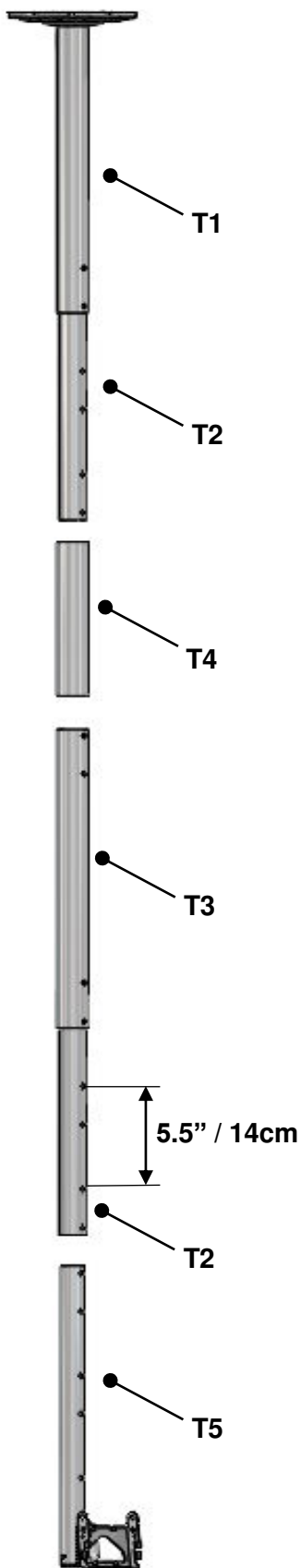
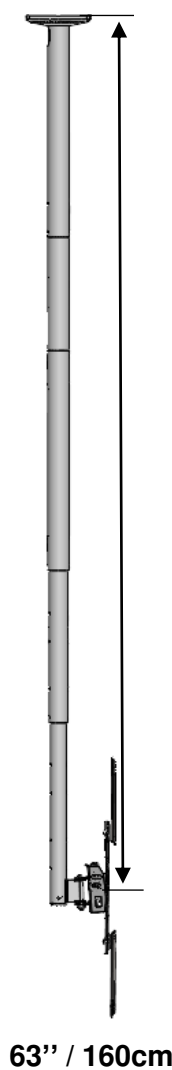
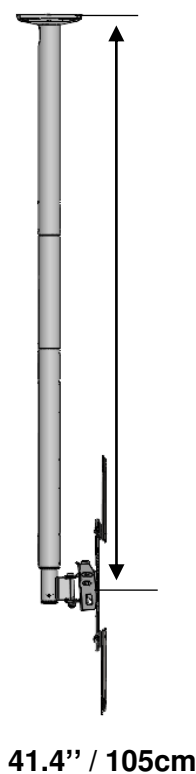

B

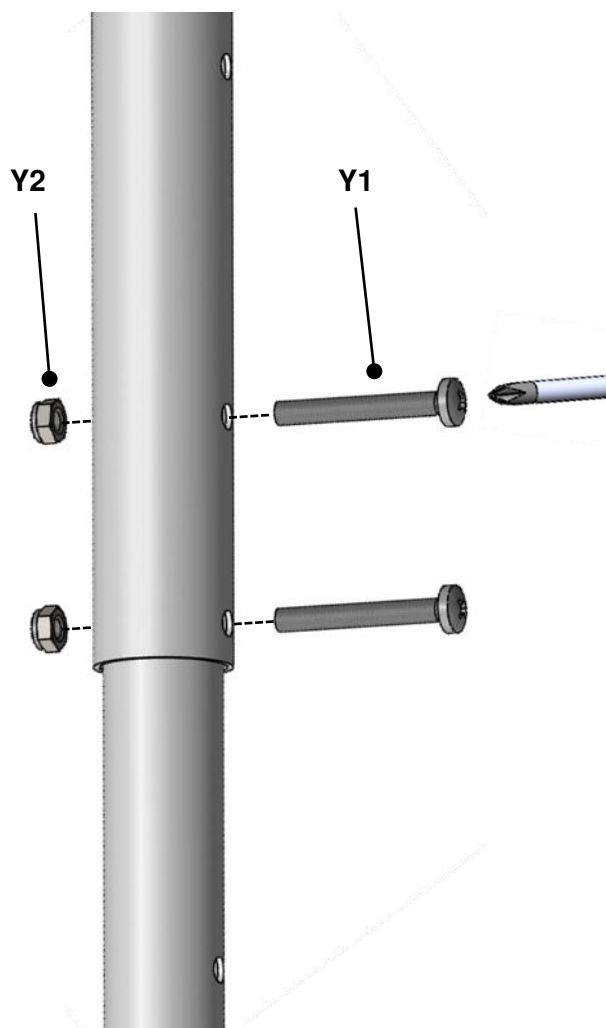

8

Place two nuts (Z8) in the nut housing (P2).

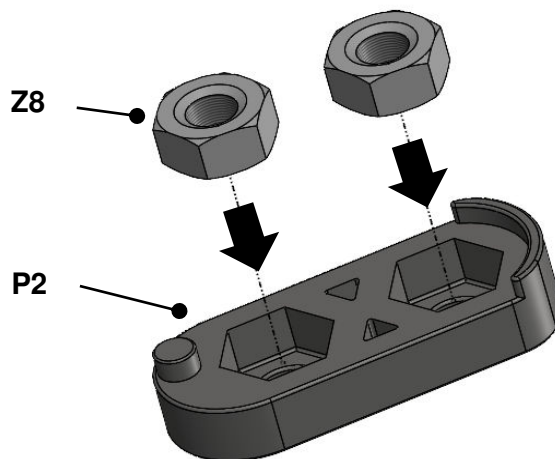

9

Attach the nut-housings (P2) to the lower pipe (T5). Make sure that the tab is inserted into the slot.

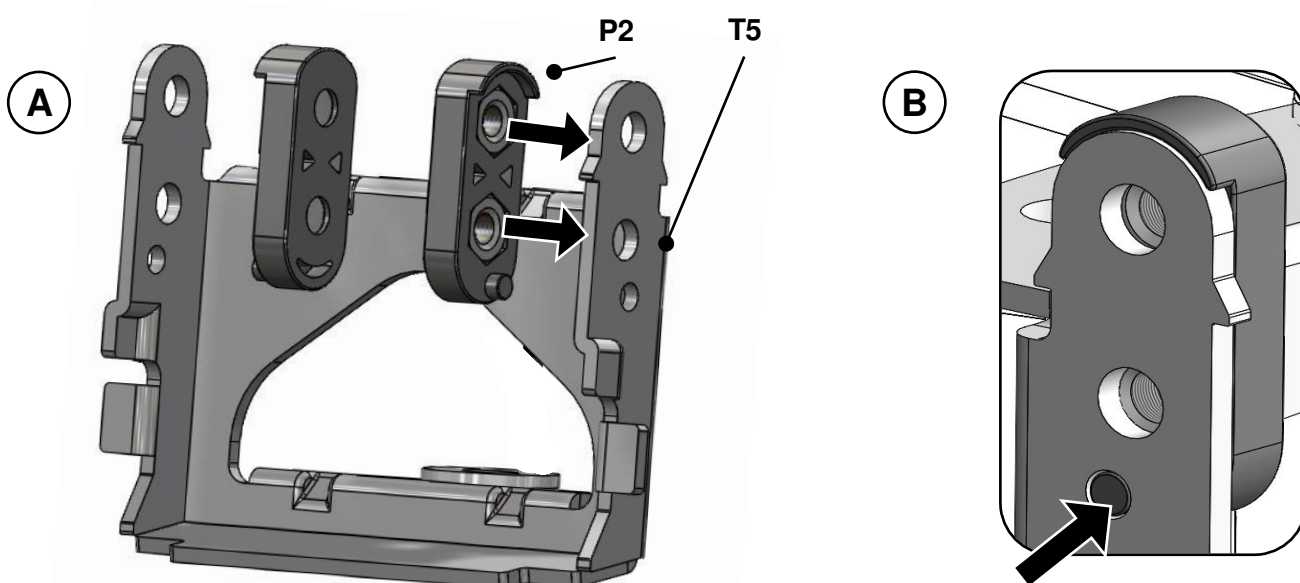

10

Push parts P3 down on the nut-housings (P2). The upside down “T” must pass the protruding tooth (shown below).

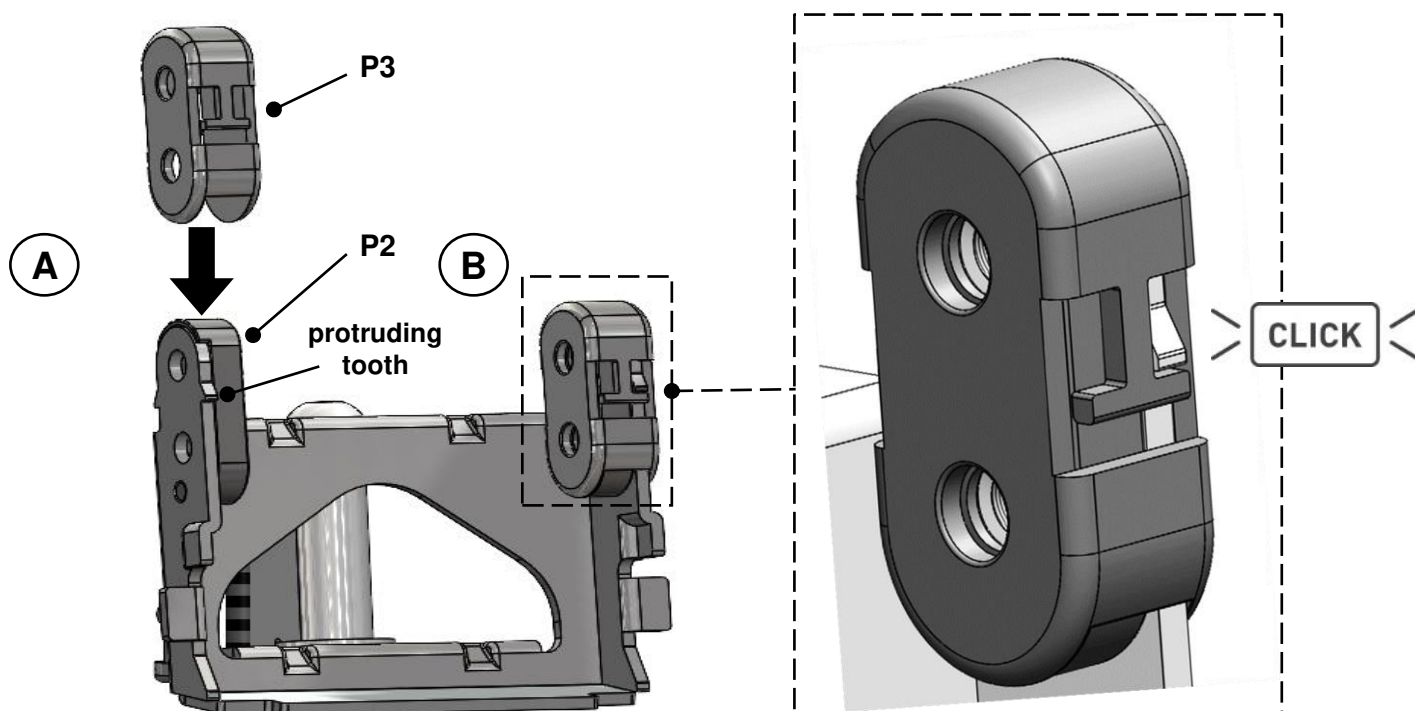

11 Pass the cables through the pipes

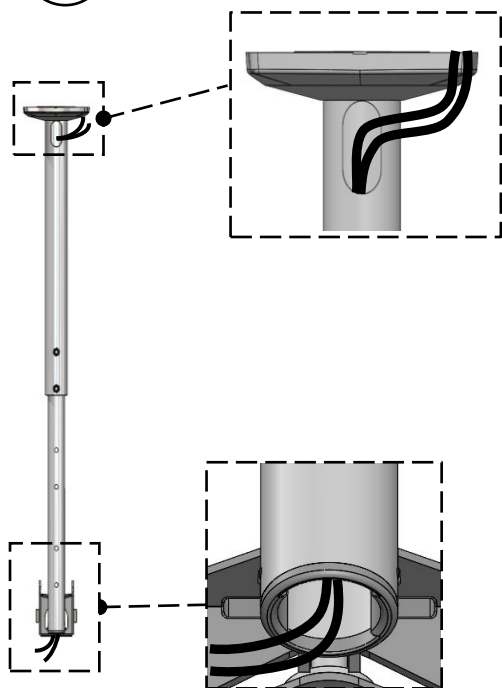

12 Connect the TV with the TV plate to the bracket

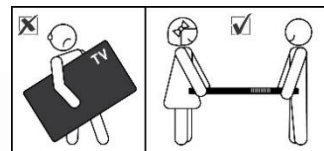
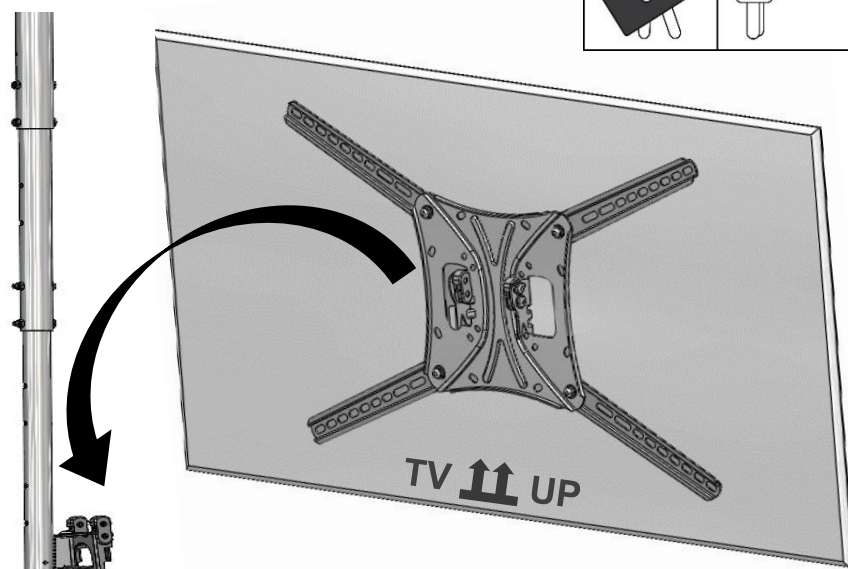

13 Insert and tighten the screws from both sides to create friction for the tilt mechanism. Adjust the TV tilt angle carefully.

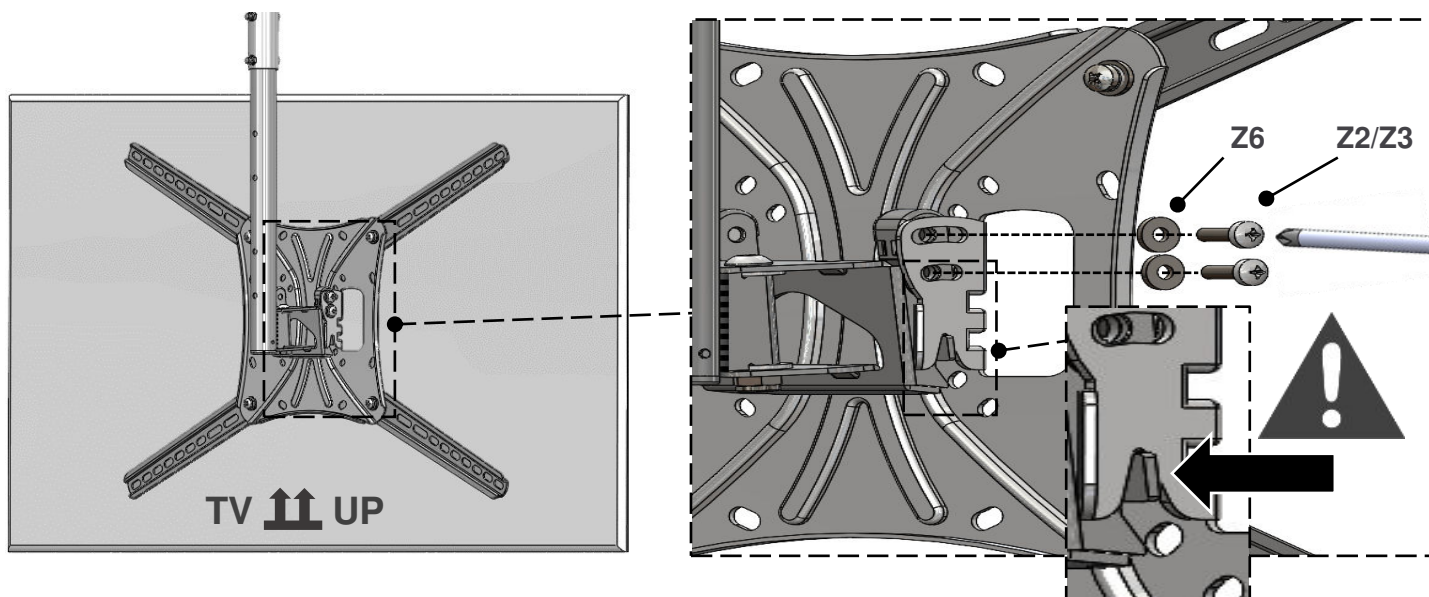

14 Level & adjust the TV

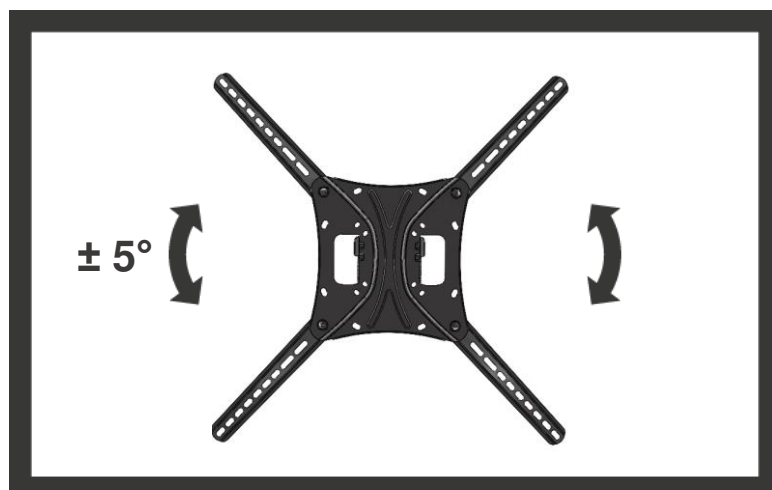
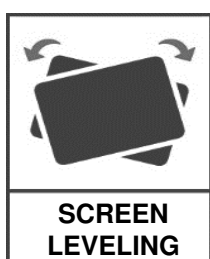

In order to disconnect the TV:

Remove the screws and lift the TV

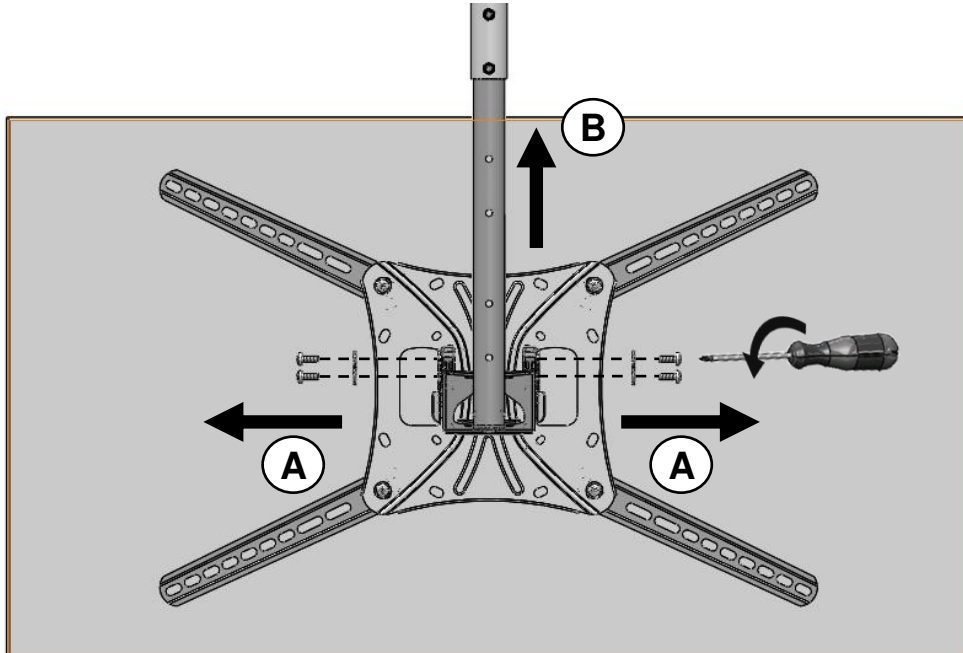
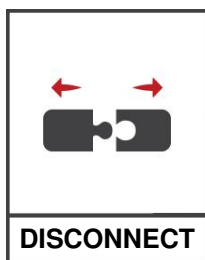

BACKSCREEN CONNECTION POSITIONING OPTIONS

All TV backscreen connections are in millimeters (Width x Height).

There are a few sizes of TV plates available.

The backscreen connections in position 1 are included in some of the different TV plates, according to their size, and do not require the use of the 4 adapters (marked in blue).

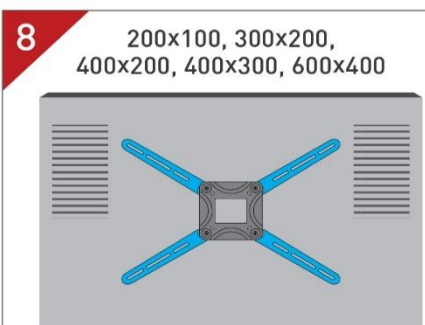
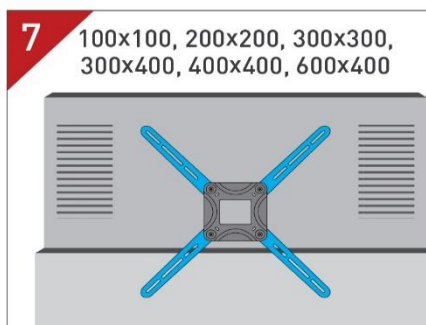
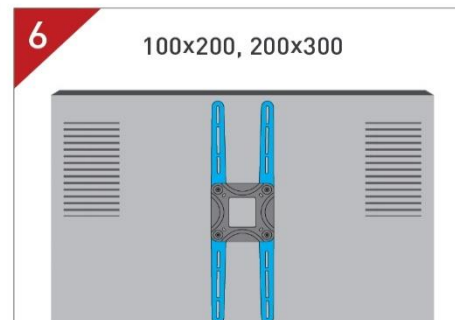
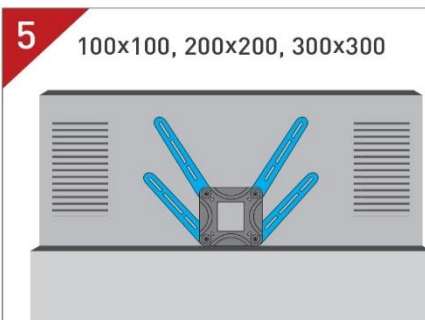
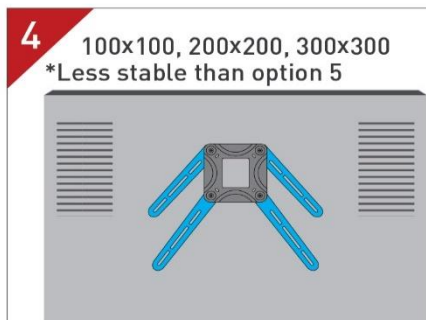
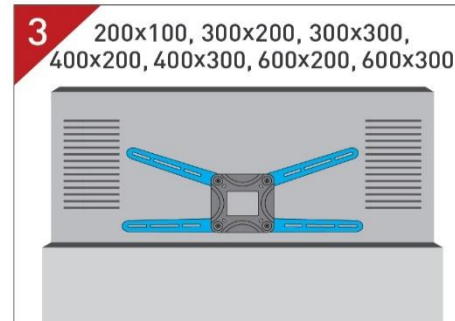
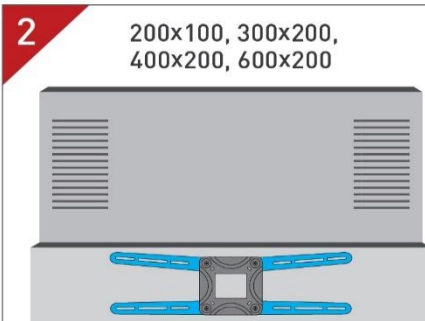
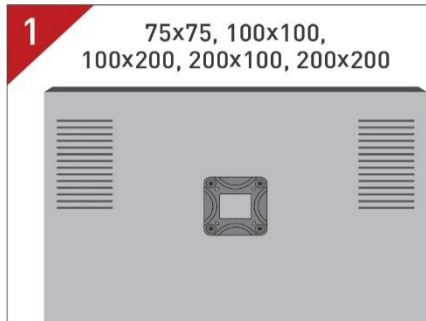

If your backscreen connections are not included in any of the positions, please contact us

www.barkanmounts.com/support

