

Series 6, Built-in oven with added steam function, 60 x 60 cm, Stainless steel
HRA558BS1



Included accessories

1 x combination grid
 1 x universal pan

The built-in oven with AutoPilot and added steam: automatically prepares your dishes so they're crispy and juicy.

- **Added steam function:** by adding steam, foods turn out crispy on the outside and juicy on the inside.
- **LCD-display control, white:** easy-to-use thanks to direct access to additional functions, temperature recommendation and temperature indication.
- **Pop-out controls:** for an easy to clean front.
- **EcoClean Direct:** easy cleaning thanks to a coating that breaks down grease while you bake.

Technical Data

Gross weight : 37.2 kg
 Color / Material Front : Stainless steel
 Built-in / Free-standing : Built-in
 Integrated Cleaning system : Ecolyse coating all sides, Hydrolytic
 Required niche size for installation (HxWxD) : 585-595 x 560-568 x 550 mm
 Dimensions : 595 x 594 x 548 mm
 Dimensions of the packed product (HxWxD) : 675 x 690 x 660 mm
 Control Panel Material : Stainless steel
 Door Material : Glass
 Net weight : 35.2 kg
 Usable volume of cavity : 71 l
 Heating modes : Bottom heat, Defrost setting, Full width grill, Hot Air, Hotair gentle, Hot air grilling, Pizza setting, Soft steaming, Top/bottom heat
 First cavity material : Other
 Number of interior lights : 1
 Length electrical supply cord : 120 cm
 Interior Lights - cavity 1 : 1
 Pull-out system : Accessory
 Clock function : Alarm, Off, On
 Included accessories : 1 x combination grid, 1 x universal pan
 Broil Element Wattages cavity 1 : 2800 W
 Convection Element Wattages cavity 1 : 2200 W
 Energy efficiency rating : A
 Energy consumption per cycle conventional (2010/30/EC) : 0.97 kWh/cycle
 Energy consumption per cycle forced air convection (2010/30/EC) : 0.81 kWh/cycle
 Energy efficiency index (2010/30/EC) : 95.3 %
 Connection Rating : 3600 W
 Fuse protection : 16 A
 Voltage : 220-240 V
 Frequency : 50; 60 Hz
 Plug type : GARDY plug w/ earthing
 Color / Material Front : Stainless steel
 Energy input : Electric
 Required cutout/niche size for installation (in) : x x
 Dimensions of the packed product : 26.57 x 25.98 x 27.16
 Net weight : 78.000 lbs
 Gross weight : 82.000 lbs
 Length electrical supply cord : 120 cm
 Net weight : 35.2 kg



Series 6, Built-in oven with added steam function, 60 x 60 cm, Stainless steel HRA558BS1

The built-in oven with AutoPilot and added steam: automatically prepares your dishes so they're crispy and juicy.

Type of oven / heating system:

- Oven with 10 heating methods: 3D hotair, Conventional heat, Hot air grilling, Full width grill, Pizza setting, Bottom heat, Low temperature cooking, Defrost, Hotair gentle, Regeneration with steam
- Heating modes combinable with steam function: 3D hotair, hotair grilling, Conventional heat
- Temperature range 30 °C - 275 °C
- Cavity volume: 71 l

Hook-in racks / rails

- Number of shelf levels: 5 PC
- Accessory

Design:

- Rotary Control, Pop-out controls
- Extra large capacity oven with grey enamel

Cleaning:

- EcoClean Direct: coating of ceiling, back panel, side liners
- EcoClean program

Comfort:

- LCD-display control (white)
- Electronic clock
- Temperature proposal
automatic start Heating-up control Sabbath setting
- AutoPilot 30
- Additional functions:
descaling programme
- Bar handle
- Supporting systems: Programs
- Rapid heating-up
- Halogen interior lighting, Switch for oven illumination
- Water tank with a volume of 220ml
- Location of the steam generator is outside of the cavity
- Integral cooling fan

Accessory:

- combination grid, universal pan

Environment and Safety:

- low door temperature
- Child lock
Automatic switch off Residual heat indicator

Technical Information

- Length of mains cable: 120 cm
- Nominal voltage: 220 - 240 V
- Total connected load electric: 3.6 KW
- Energy efficiency rating (acc. EU Nr. 65/2014): A(at a range of energy efficiency classes from A+++ to D)
Energy consumption per cycle in conventional mode:0.97 kWh
Energy consumption per cycle in fan-forced convection mode:0.81 kWh
Number of cavities: 1 Heat source: electrical Cavity volume:71 l

Dimensions:

- Appliance dimension (hxwxh): 595 mm x 594 mm x 548 mm
- Niche dimension (hxwxh): 585 mm - 595 mm x 560 mm - 568 mm x 550 mm
- "Please reference the built-in dimensions provided in the installation drawing"
- We recommend you to choose complementary products within Series 6, in order to assure an optimal design combination of your Built-In appliances.

**Series 6, Built-in oven with added steam function, 60 x 60 cm, Stainless steel
HRA558BS1**

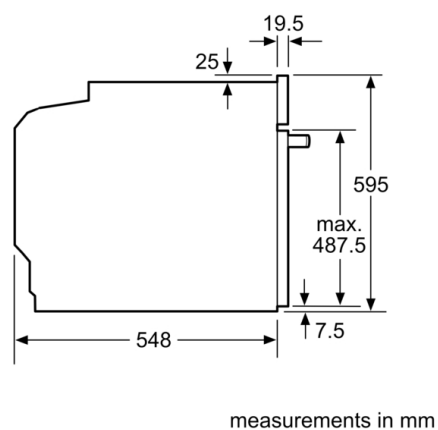
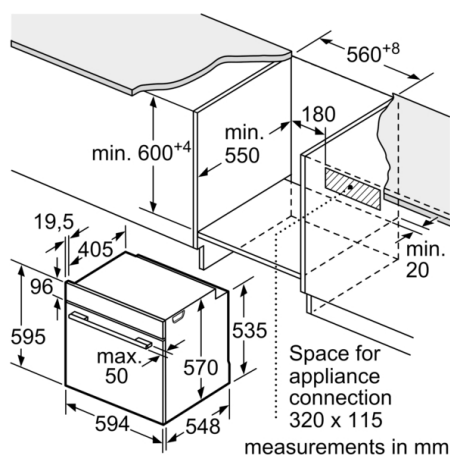

Installation with a hob.

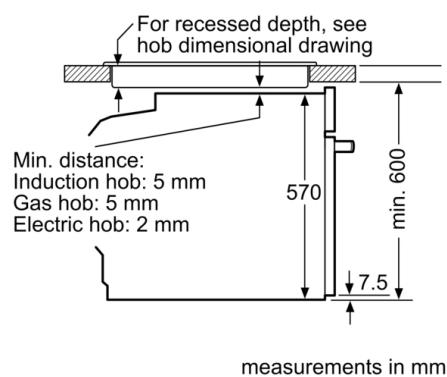

Measurements in mm

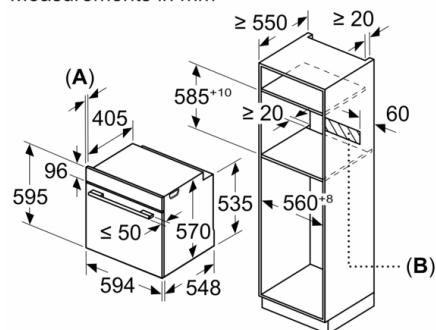

A: 19.5 mm
B: Space for appliance connection 320 x 115 mm